

CURRENT TRANSFORMERS

Window diameter 8.10".
Models 81113 RW & SH.

Fully encapsulated.
Indoor/outdoor applications.

Standard 5-amp secondary.
Others available.

APPLICATION:

For Metering, Wattmeters, Ammeters and Relays.

CONTINUOUS THERMAL RATING:

1.33 at 30 C. amb.; 1.0 at 55 C. amb. Average.

INSULATION CLASS:

0.6 kV. BIL 10kV. full wave.

50-400 Hz.

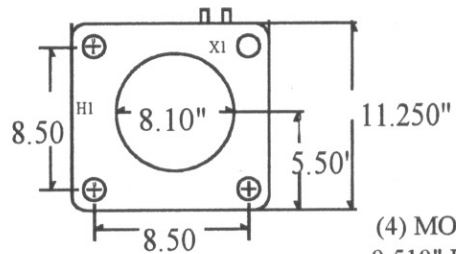
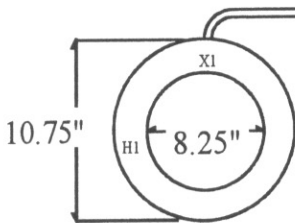
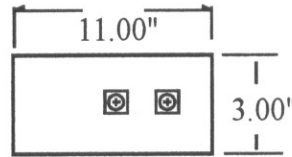
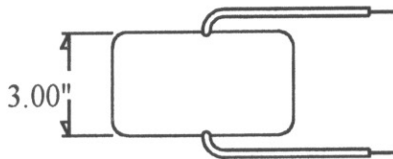

(4) MOUNT HOLES
0.510" DIAMETER.

Model 81113RW-**

Model 81113SH-**

CSA Optional.

- Flexible leads are UL 3174 150 degree C. CSA approved, #12 AWG 24" long.
- Non-Standard length to be specified.
- Terminals are brass No. 10-32 UNC.
- Mounting brackets optional, order No. 8111-MBK.
- Approximate weight 22 lbs.
- Additional ratios available.

NOTE: 2400:5 and up has an Rf. of 1 @ 30 C. amb.

CATALOG NUMBER	CURRENT RATIO	RELAY CLASS	ANSI METERING CLASS AT 60 Hz				
			B0.1	B0.2	B0.5	B0.9	B1.8
** -100	100:5	-	2.4	4.8	-	-	-
** -200	200:5	C20	1.2	1.2	2.4	4.8	-
** -400	400:5	C20	0.6	0.6	0.6	1.2	2.4
** -500	500:5	C50	0.3	0.3	0.6	1.2	2.4
** -600	600:5	C50	0.3	0.3	0.6	1.2	1.2
** -800	800:5	C50	0.3	0.3	0.3	0.6	0.6
** -1000	1000:5	C100	0.3	0.3	0.3	0.3	0.6
** -1200	1200:5	C100	0.3	0.3	0.3	0.3	0.3
** -1500	1500:5	C100	0.3	0.3	0.3	0.3	0.3
** -2000	2000:5	C100	0.3	0.3	0.3	0.3	0.3
** -2500	2500:5	C100	0.3	0.3	0.3	0.3	0.3
** -3000	3000:5	C100	0.3	0.3	0.3	0.3	0.3
** -4000	4000:5	C100	0.3	0.3	0.3	0.3	0.3
** -5000	5000:5	C100	0.3	0.3	0.3	0.3	0.3
** -6000	6000:5	C100	0.3	0.3	0.3	0.3	0.3